

## LED Illumination



### LED ringlight 66/40

The LED ringlight (40 LEDs) provides bright and homogenous object illumination and is designed for 66 mm lens diameter microscopes. The ringlight is secured by means of a screw and spring to protect the lens.



### LED ringlight 38/20

This smaller LED ringlight (20 LEDs) provides bright and homogenous illumination for the whole working space. It is designed for 38 mm diameter lenses and can be mounted using screws without damaging the lens.



### LED-spot

The LED spot (19 LEDs) can be attached directly to the microscope or positioned as required by means of a gooseneck and a base plate.



### LED-Spot 2-arm

Two LED-Spots in combination with a two-arm gooseneck, which can be attached on a microscope-stative. The two spots can be operated alternately with the LED segment control unit.



### Universal backlight

This transmitted light illuminator can be positioned on the stereomicroscope work surface and features exceptionally uniform daylight-quality illumination, long-life LEDs and a compact design.



### Control Unit

The compact control unit features an ON-OFF switch, an infinitely adjustable brightness regulator with a "turbo range", and two connection sockets for accommodating the LED illumination units.



### LED-ringlight with segment control 66/40

This LED illumination system was developed for lighting tasks in the field of stereomicroscopy for industrial and laboratory uses. Using the new developed control unit, all LED units (ring light 66/40, 38/20, spotlight and back light) may be partially activated, with the individual segments being rotated using a control switch. The following matter can be selected in this way:

- Semi-Circle
- Quater-circle
- Two quater-circle
- Complete circle

A ring light 66/40, one or two spots, a ring light 38/20, or a back light may be connected to the control unit. The segments are controlled by the on/off switch and the rotation can be activated using the control switch.



### LED-ringlight with segment control 66/80

The LRD ring light 66/80 guarantees optimum recognition of contrasts on a wide variety of surface structures for numerous application options in stereomicroscopy.



The control unit enables segment selection with an on/off switch, buttons can be used to rotate the selected segments with two buttons available for direction changes. The rotary potentiometer can be used to infinitely adjust the brightness level. The following segments can be selected in this matter:

- Semi-circle
- Quater-circle
- Two quater-circle
- Complete circle

The LED ringlight 66/80 can only be operated by the LED- control unit with segment control.

## LED Illumination Accessories



Colour filters for spot



Polarizing filter set

This set consists of a polarizer and an analyser and eliminate reflections. It is inserted into the ringlight.



Adapter for ringlights

There are a wide range of adapters for microscopes / microscope lenses when standard 66mm diameter ringlights cannot be attached. If required, customised adapters can be supplied.



Goose neck light guides

In single or dual leg versions, these light guides also allow spot illumination. A semi-rigid protective or sheathed tube permits the light guide to be positioned in the directions required.



Base plate

The base plate can be used in combination with a gooseneck to optimally position a light guide and to operate the ringlight in stand-alone mode. Color Filter

### LED-SETS

(consist of ringlight, spot or backlight, power supply, control unit, not including power cord)

LED-Set Ringlight 66 mm 10001  
LED-Set Ringlight 36 mm 10009

LED-Set 1 Spot 10002  
LED-Set 2 Spots 10003  
Additional Spot for ringlight 619-20-011

LED-Set Universal Backlight 10007  
Universal Backlight 619-20-032

Power cord:  
Power cord EU ELN-3.001  
Power cord CH ELN-3.002  
Power cord USA/Can/J ELN-3.003  
Power cord UK ELN-3.004  
Power cord AUS ELN-3.006  
Power cord ITA ELN-3.009

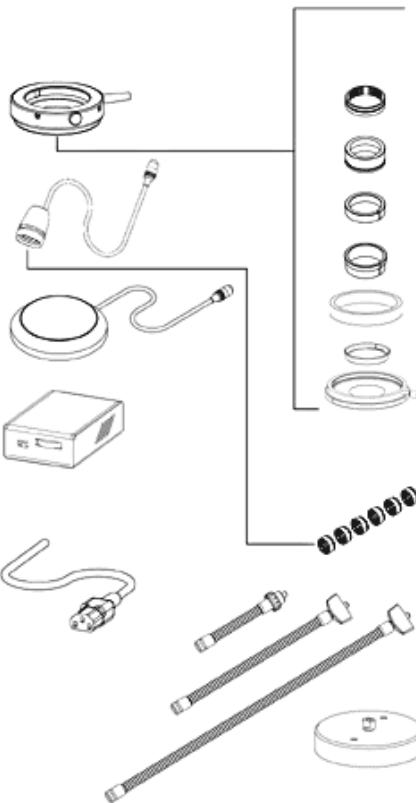

### ACCESSORIES RINGLIGHT

Adapter:  
66/58 595-32-258  
for Olympus SZ-III+SZ-60, SZ-1145 (66/54 mm) 598-30-002  
for Olympus SD/SF/SZ w lens attachment (66/50 mm) 598-30-017  
for Nikon (except SMZ1) (66/47 mm) 598-30-004  
for Nikon SMZ 800/1000/1500/SMZ/U, 10 A 598-32-043  
for Olympus SZH/SZX-9/SZX-12 (66/60 mm) 598-32-043  
for Nikon SMZ1/1B/2B/2T (66 mm/M48 x 0,75) 598-32-049  
for Olympus SD/SF/SZ w/o lens attachment 598-32-049  
for Nikon SMZ-645/SMZ-660 (66 mm/M55 x 0,75) 598-32-050

Universal Adapter  
for objectives with diameters between 38 and 58 mm 598-30-022

Polarisation filter-set  
Analyser und Polariser 40/66 619-20-021

### ACCESSORIES SPOT

Filter:  
blue 619-30-010  
green 619-30-011  
yellow 619-30-012  
red 619-30-013

Gooseneck:  
L = 85 mm 619-30-003  
L = 200 mm 619-30-004  
L = 300 mm 619-30-005

Base plate with M5 screw 619-30-007